



Douglas Road

HORFIELD

APPROXIMATE FLOOR AREA
101 SQM / 1092 SQFT



GROUND FLOOR

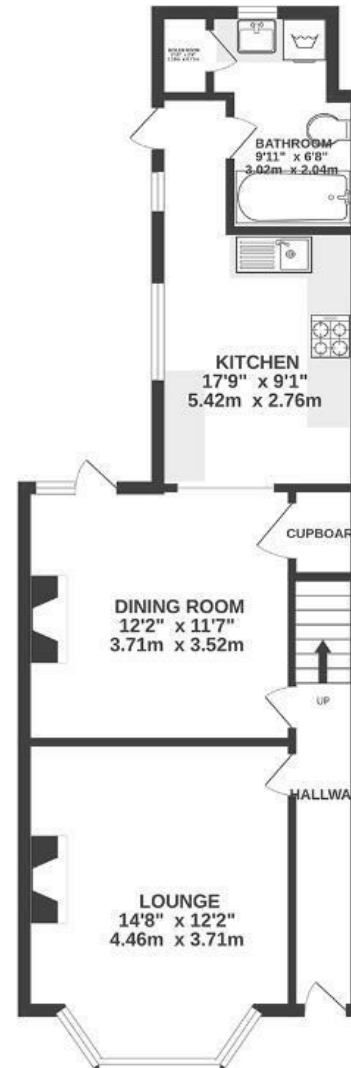

FIRST FLOOR



Boardwalk

Douglas Road

HORFIELD, BRISTOL



£425,000



3 Bedrooms



BS7 0JE



2 Bathrooms

"It's a beautiful Victorian home in a great location, set on a quiet, friendly street close to Gloucester Road, good schools, public transport, hospitals, and the leisure centre. Full of character, the property has high ceilings, spacious rooms, and a bright kitchen/diner perfect for family life and entertaining. The kitchen and bathrooms are in excellent condition, all bedrooms fit double beds, and the low-maintenance gardens make for easy living. There is also potential to extend into the loft."

